

Granny Square month 2021 CAL



Day 12

Instagram [@makingpolly](https://www.instagram.com/makingpolly)

My name is Pauline. I live in a small village in Scotland with my husband and 3 children who are 9, 6 and 4. These are the little people who give me so much inspiration in my work, along with all my collections of quirky vintage bits and bobs. My gran taught me to knit when I was a child but then I didn't knit until I was much older, at a time when I needed a hobby. It was then I became interested in crochet. I had never crocheted before so I started to learn with the help of YouTube. It took a while but when I got it I fell in love with the craft! I started in 2013 and my love of crochet grows all the time. I love making cute, colourful and kooky creations and my favourite type of crochet is amigurumi. I studied as an architect so design is something I feel passionate about and I am now working on the many crochet design ideas I have.

What you need:

Knitcraft Cotton Blend DK weight yarn in:

- Light Blue
- Mustard
- Teal
- Hot Pink
- White
- Red (optional for finishing details)

5mm Hook

2.5mm Hook (optional for finishing details)

Scissors

Wool needle for weaving in ends and for optional finishing details



Stitch Abbreviations and Special Stitch Instructions:

ch Chain
dc Double Crochet
rs Right Side
ws Wrong Side
sk Skip
slst Slip Stitch
mr Magic Ring
FO Fasten Off
yo Yarn Over

ldtr Long Double Treble (yo twice, insert hook in designated stitch, yo, draw up a loop, [yo, draw through 2 loops] 3 times)

lbobble Large Bobble (yo twice, insert hook in designated stitch, yo, draw up a loop, [yo, draw through 2 loops] twice) 7 times in same st, yo, draw through all 8 loops on hook)

Finished Dimensions:

20cm x 20cm

Granny Square:

With Light Blue Ch30

Row 1 ws: dc in 2nd chain from the hook, 28dc, ch1, turn (29)

Row 2–9 (8 rows): 29dc, ch1, turn (290)

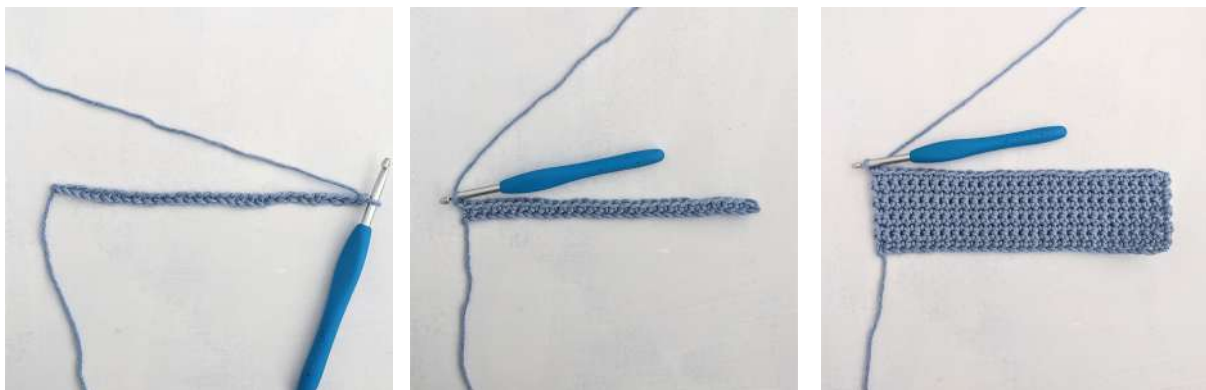

Note 1: When changing from light blue to mustard, on the next row, drop the light blue but do not FO, pick up again at the colour change back to light blue and then FO the mustard.

Row 10: 6dc, change to Mustard, 3ltdr around post of next stitch on row 6, ** change to Light Blue, 7dc, change to Mustard, 3ltdr around post of next stitch on row 6* Repeat from ** to * once more, change to Light Blue, 6dc, ch1, turn (26 dcs, 3 skipped dcs, 3 groups of 3ltdr)

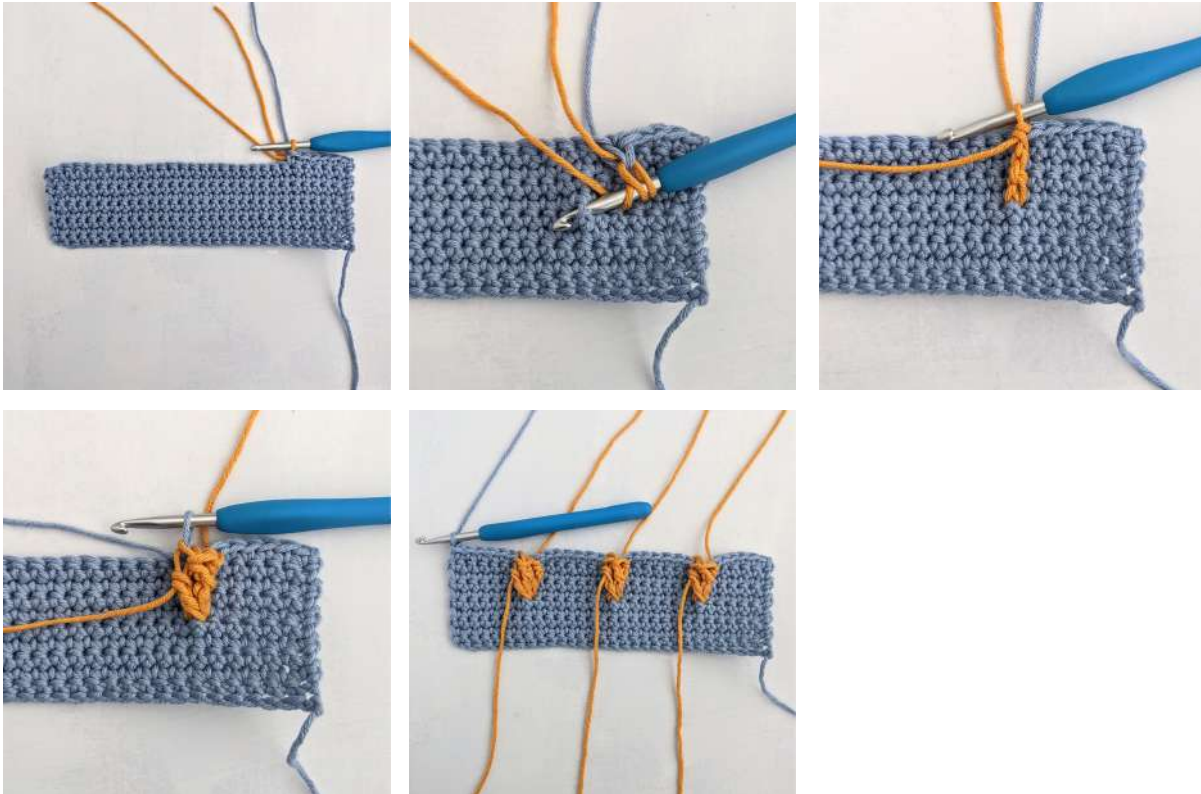

Note 2: Sew both mustard ends behind to the top of the 3ltdr ice cream cone and then tie both ends together in a knot.

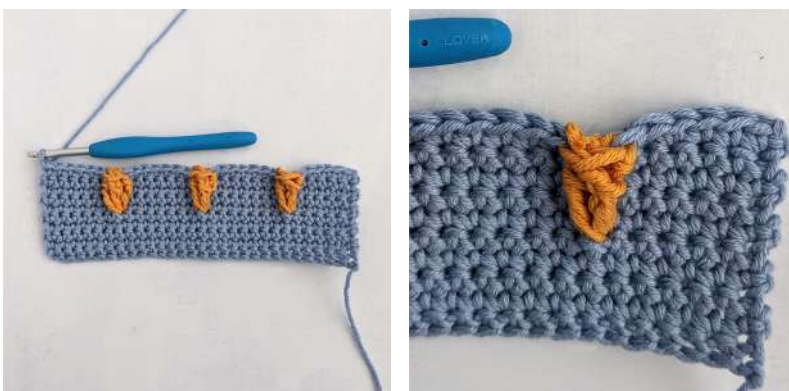

Note 3: When working the Lbobbles in the next row, work into the skipped dcs on the row below. Carry the Light Blue yarn through and as you insert the hook into the stitch pick up the Light Blue strand that crosses over on the ws, from the colour changes on the previous row and the mustard ends that are knotted together. This will help achieve a clean finish with those parts hidden.

Row 11 ws: 6dc, change to Hot Pink, Lbobble in next skipped dc on row 10, ch1, change to Light Blue on next dc, 6dc, change to Teal, Lbobble in next skipped dc on row 10, ch1, change to Light Blue on next dc, 6dc, change to White, Lbobble in next skipped dc on row 10, ch1, change to Light Blue on next dc, 5dc, ch1, turn (26 dc, 3Lbobbles, 3chs)

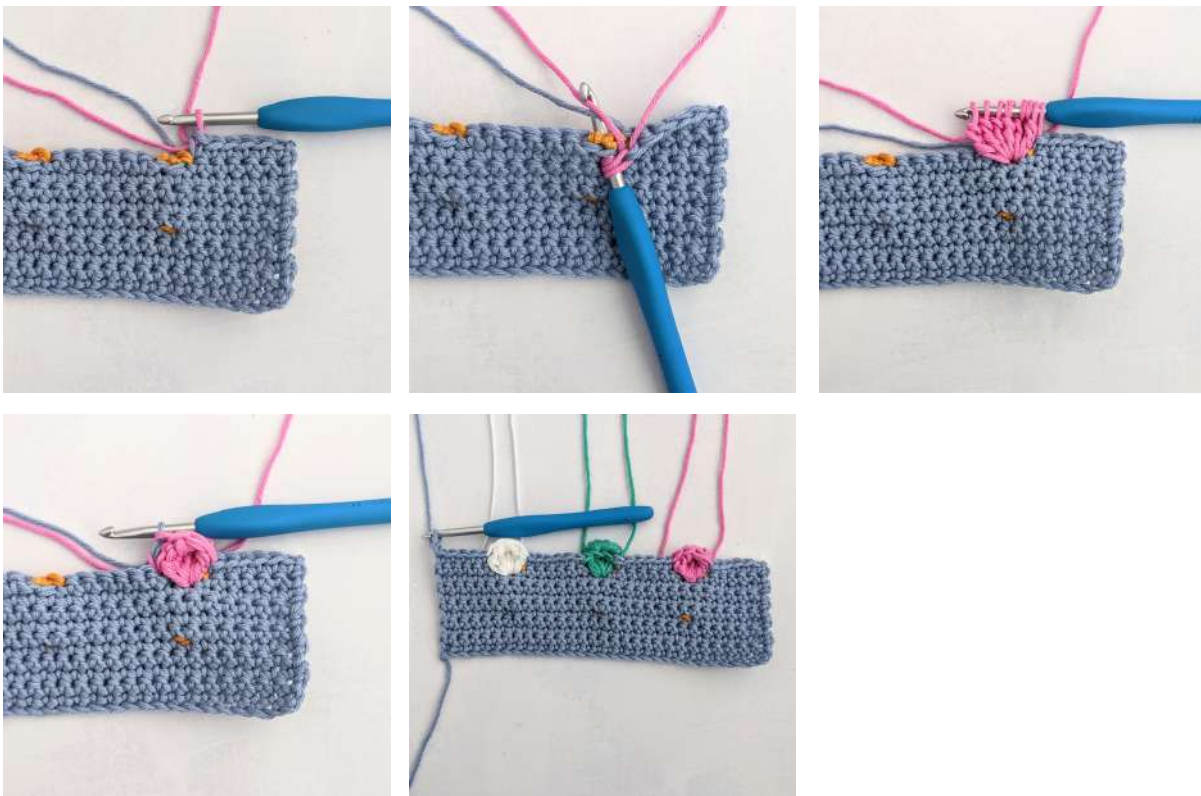

Note 4: Sew all the ice cream Lbobble ends behind each of the ice creams Lbobble but do not FO. We will use these ends later in the finishing details



Row 12: 6dc, [slst next ch, 8dc] 2 times, sk next ch, 7dc, ch1, turn (29)

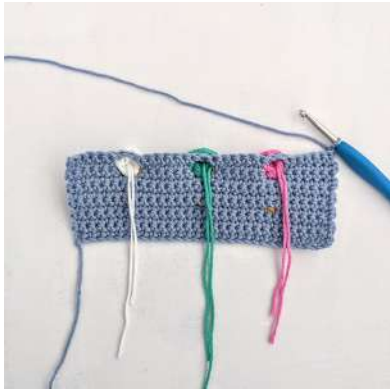

Row 13–19 (7 rows): 29dc, ch1, turn (29)



(See Note 1 above)

Row 20: 6dc, change to Mustard, 3ltdr around post of next stitch on row 16, ** change to Light Blue, 7dc, change to Mustard, 3ltdr around post of next stitch on row 6* Repeat from ** to * once more, change to Light Blue, 6dc, ch1, turn (26 dcs, 3 skipped dcs, 3 groups of 3ltdr)



(See Note 2 above)

(See Note 3 above)

Row 21 ws: 6dc, change to White, Lbobble in next skipped dc on row 10, ch1, change to Light Blue on next dc, 6dc, change to Hot Pink, Lbobble in next skipped dc on row 10, ch1, change to Light Blue on next dc, 6dc, change to Teal, Lbobble in next skipped dc on row 10, ch1, change to Light Blue on next dc, 5dc, ch1, turn (26 dc, 3Lbobbles, 3chs)



Row 22: 6dc, [sk next ch, 8dc] 2 times, sk next ch, 7dc, ch1, turn (29)

Row 23 – 29 (7 rows): 29dc, ch1, turn (29)



(See Note 1 above)

Row 30: 6dc, change to Mustard, 3ltdr around post of next stitch on row 26, ** change to Light Blue, 7dc, change to Mustard, 3ltdr around post of next stitch on row 6* Repeat from ** to * once more, change to Light Blue, 6dc, ch1, turn (26 dcs, 3 skipped dcs, 3 groups of 3ltdr)



(See Note 2 above)

(See Note 3 above)

Row 31 ws: 6dc, change to Teal, Lbobble in next skipped dc on row 10, ch1, change to Light Blue on next dc, 6dc, change to White, Lbobble in next skipped dc on row 10, ch1, change to Light Blue on next dc, 6dc, change to Hot Pink, Lbobble in next skipped dc on row 10, ch1, change to Light Blue on next dc, 5dc, ch1, turn (26 dc, 3Lbobbles, 3chs)



Row 32 : 6dc, [sk next ch, 8dc] 2 times, sk next ch, 7dc, ch1, turn (29)

Row 33 -35 (3 rows): 29dc, ch1,turn. (29)

Row 36:29dc, change to White, ch1, do not turn (29)



Border rs: rotate and dc in the corner, *1dc in each row along the side, [dc, ch1, dc] in the corner, 2dc in next stitch, 3dc, 2dc in next stitch, 4dc, 2dc in next stitch, 3dc, 2dc in next stitch, 3dc, 2dc in next stitch, 4dc, 2dc in next stitch, 3dc, 2dc in next stitch**, [dc, ch1, dc], rep from * to **, dc in corner, ch1, FO (144dc, 4chs)



You can leave your ice creams plain and sew in all the ends or add some optional finishing details before sewing in all the ends.

Finishing Details (optional):

Feel free to use 1, 2 or all 3 of the ice cream topping details below. I have used all 3 and each coloured ice cream has been finished with each topping detail but feel free to put your toppings on any of the ice creams. For crocheting the flake and the cherry you will use the 2.5mm hook to achieve tighter crochet.

Sprinkles

Add sprinkles by sewing yarn first from back to front of the ice cream Lbobble and then taking the needle from front to back leaving a little length of the yarn showing on the front of the ice cream bobble. Repeat this a few times trying to hide the yarn at the back of the ice cream Lbobble as much as possible. For the teal ice cream Lbobble use hot pink, white and red. For the hot pink ice cream Lbobble use teal, white and red. For the white ice cream Lbobble use teal, hot pink and red.



Flake

Using the 2.5mm hook and with the hot pink and mustard ch5, then slst in the 2nd chain from the hook and the next 3 chains, ch1 and FO

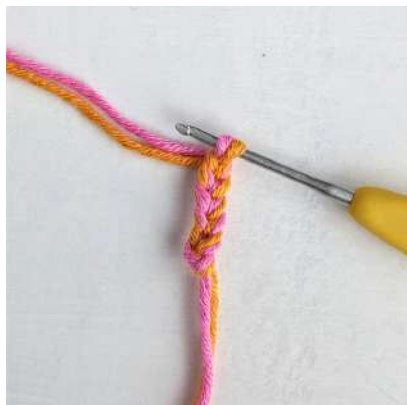

Sew the flakes with the back facing out. Sew 3 of the ends to the back of the square at the top right of the ice cream bobble. Use the 4th end to surface sew along the square and then into the underside of the flake. Repeat around the flake and then sew the end to the back of the square.



Cherry

Using the 2.5mm hook and with red 6dc in a mr, slst to first dc and FO

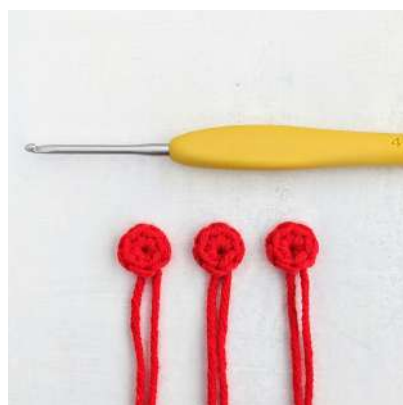
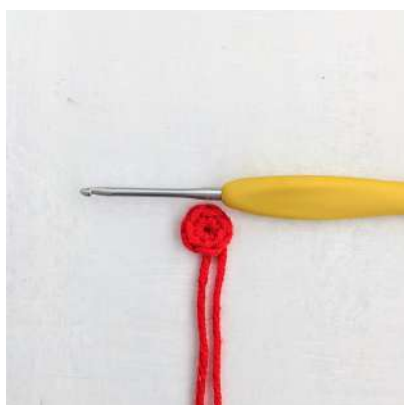
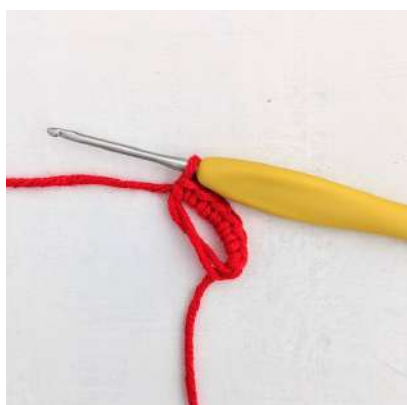

Sew the cherries on in the same way as the flakes. With teal surface sew a couple of stitches for the cherry leaves.

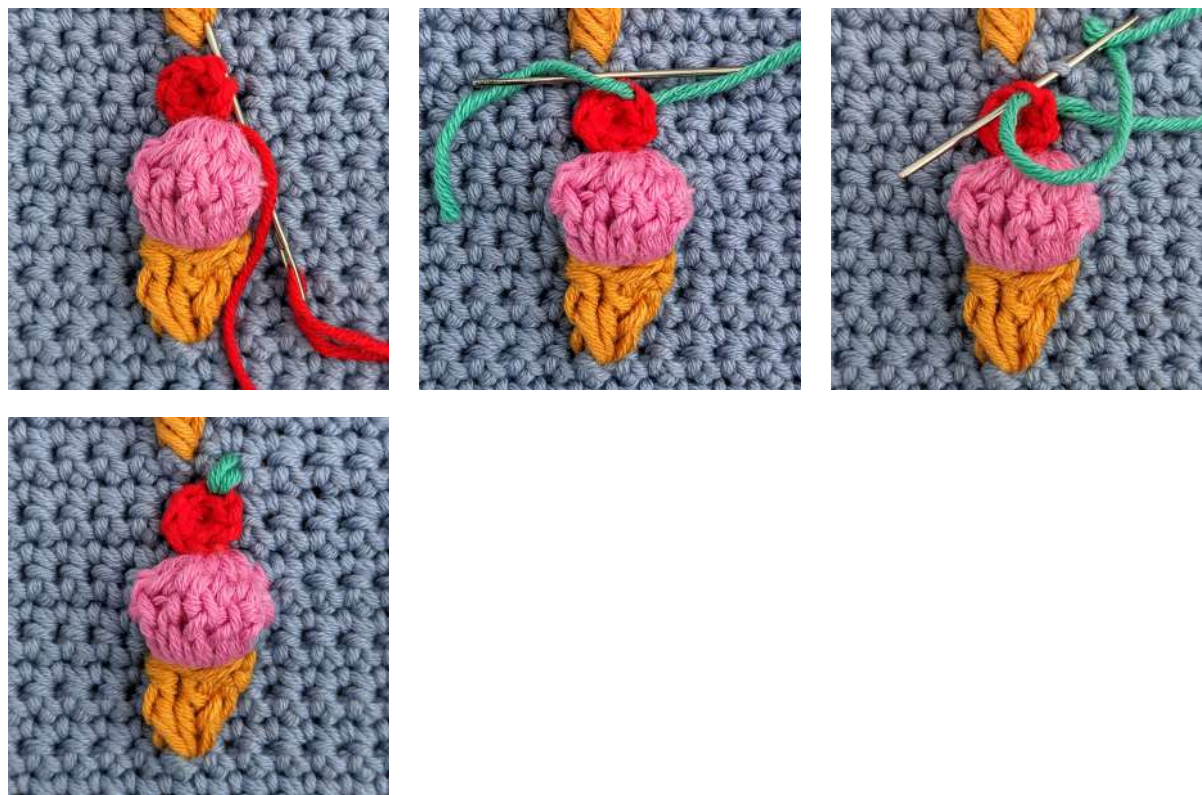

When you have finished your granny square either with or without the finishing touches sew in all the ends. Sew in the ends from the flake, cherries and sprinkles into the back of the ice cream Lbobbles. Sew in the ends of the ice cream Lbobbles using them to hide the other sewn in yarn colours.

**You've now completed
your granny square!**

Don't forget to head back to the blog where a new square will be released at 10 am, Monday to Saturday.

<https://www.hobbycraft.co.uk/ideas/knitcraft/granny-square-month-cal-2021>



SCAN ME



Please note: This pattern is for personal use only.